



Club & Ball Washer

2907 29th Ave. E
 Bradenton, FL 34208
 (941) 746-7844

UNIV. ADJUSTABLE / POST



Part# UN1001

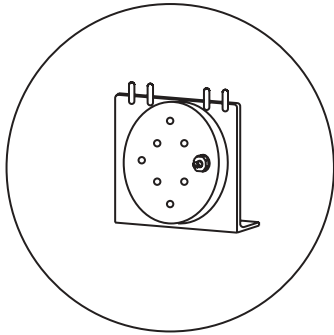

Parts A, B, and C come pre-assembled from the factory for easy assembly.

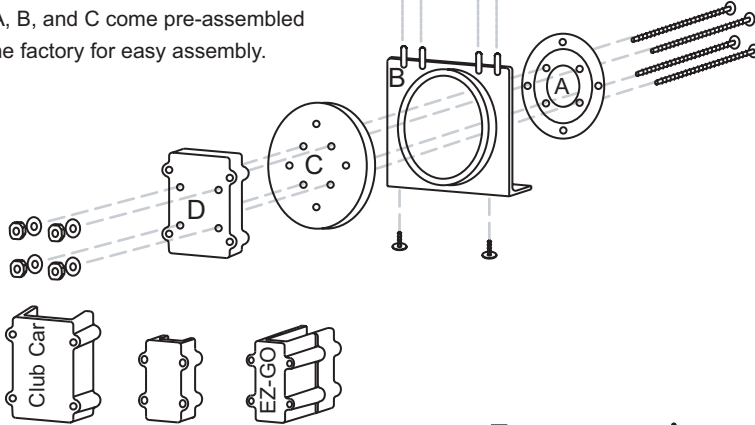
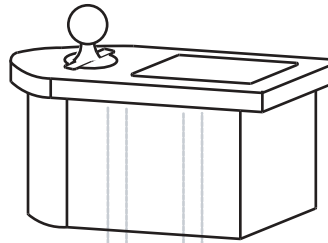



Instructions

- 1) Parts A,B and C have been pre-assembled for use with a 1" spacing application.
- 2) For a 2" spacing application, remove 1" bolt, and replace, with the enclosed 4" bolts.
- 3) Turning the Club and Ball Washer, Inc. unit upside down, place the four insertion pins on the "L Bracket" into the unit. Take the two black screws and insert into matching screw bosses on the bottom of the case.
 NOTE: There are four holes available, but only two will be used, this is to allow for the right or left side mounting option.
- 4) Use one of the four different caps provided. Cap marked "EZ-GO" will work for post 3/4" wide x 1-5/8" deep. The cap marked "Club Car", will work for a post 2" wide x 1" deep. The cap with no marking will work for a post 1" wide x 1" deep. Part "D" can be used in conjunction with Club Car cap or the unmarked cap as a spacer to take up excess bolt length. Part "D" can also be used to mount the Ball Washer unit to a sweater basket by sandwiching parts "C & D" between the wires of the basket. This will require either four 1-3/4" or 2" carriage bolts, depending on basket design.
 NOTE: These bolts are not supplied with this kit.
- 5) Place the four washers on the carriage bolts followed by four lock washers and nuts, then tighten as needed.

Parts List

1. (1) Part A
2. (1) Part B
3. (1) Part C
4. (1) Part D (Can be used as a spacer in conjunction with the Club Car cap. Part D can also be used to fasten bracket to sweater basket using 2" carriage bolts. Not supplied with this kit)
5. (1) EZ-GO Post Cap
 3/4" x 1-3/4" Post
6. (1) Club Car Post Cap 1" x 2" Post
7. (1) 1" x 1" Post Cap
8. (4) 1/4-20 x 4" Carriage Bolts
9. (4) 1/4" Flat Washer
10. (4) 1/4" Lock Washers
11. (4) 1/4" Nuts
12. (2) #10-3/4" Phillips Head Screws

Tools Required

- | | |
|---|-------------|
|  | 7/16 Wrench |
|  | #2 Phillips |